

How to Measure Outdoor Pizza Oven Covers - Design 5

Measurement Instruction

- ✓ Give exact measurement from edge to edge.
- ✓ We add 1" to 2" leeway on the given width/depth for easy pull-in and pull-out.
- ✓ The height dimensions will remain same as provided by you.

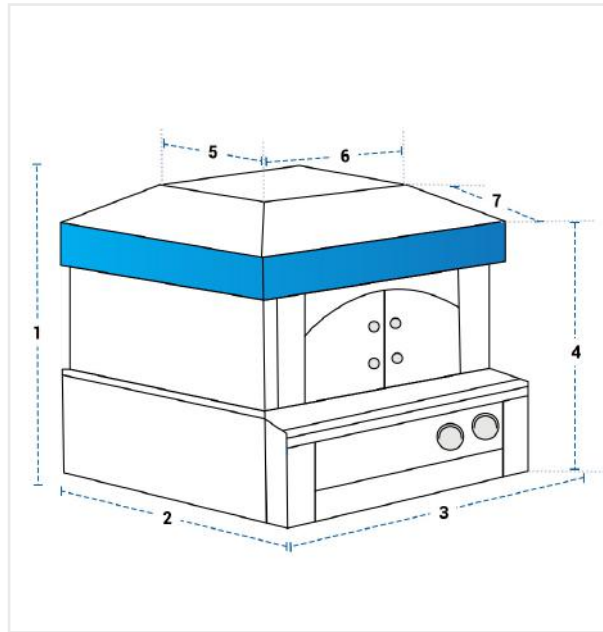

Measurement (Inches)

1. Total Height

3. Bottom Width

5. Top Depth

7. Inclined Length

2. Bottom Depth

4. Front Height

6. Top Width

1. Total Height:
Total Height of the Outdoor Pizza Oven

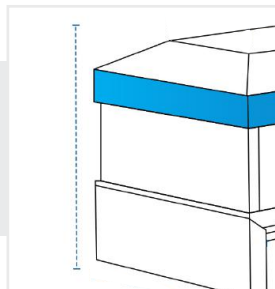

2. Bottom Depth:
Bottom Depth of the Outdoor Pizza Oven

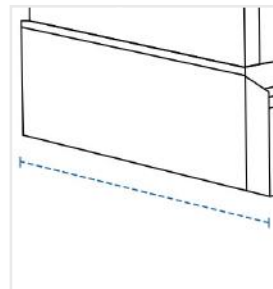

3. Bottom Width:
Bottom Width of the Outdoor Pizza Oven

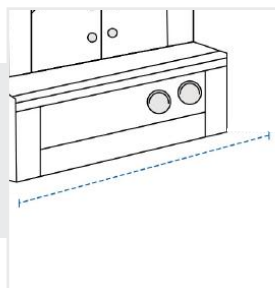

4. Front Height:
Front Height of the Outdoor Pizza Oven

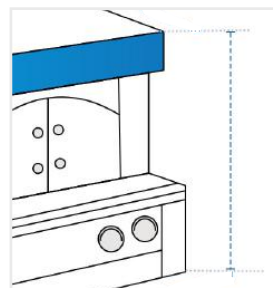

5. Top Depth:
Top Depth of the Outdoor Pizza Oven

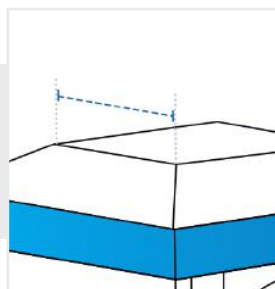

6. Top Width:
Top Width of the Outdoor Pizza Oven

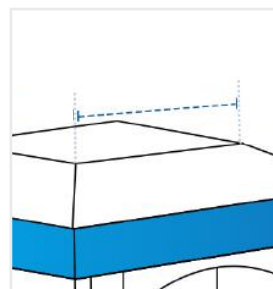

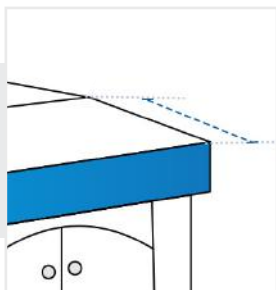

7. Inclined Length:
Inclined Length of the
Outdoor Pizza Oven